

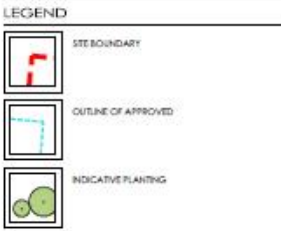

NOTES

- The content of this drawing are copyright.
- Do not scale. Approx dimensions only to be used.
- Contractor must verify all dimensions and report any discrepancies before putting work in hand or making any deep drawings.
- All lot levels to be checked with a cross-site system.
- Flow rates to be checked with a site specific model.
- A flood risk for the site has been assessed and it is considered that the site is not at risk of flooding.



SITE AREA = 1.265 HECTARES / 3.149 ACRES

No.	Revision	date	by

PROPOSED DEVELOPMENT,
 HOBURNE FARM,
 CHRISTCHURCH,
 DORSET,
 BH 23 4HU.

SITE PLAN

scale	checked
A3 SHOWN @ 1:250	
date JANUARY 2017	down JAW/D

8825 - 100

ARC Architecture Ltd.

Chapman Way, 14 Parnwell,
 Christchurch, Dorset, BH23 1EP
 Tel: +44 (0) 1302 479919
 Email: enquiries@arc-architecture.co.uk
 Web: www.arc-architecture.co.uk

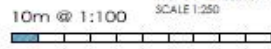

SITE PLAN: BASED ON TOPOGRAPHICAL INFORMATION
 SCALE 1:250

PRELIMINARY